

INSTRUCTIONS

#SGSPEZ

STEELCLUB® GRAPHITE SHAFT PULLER

Commercial EZ Model

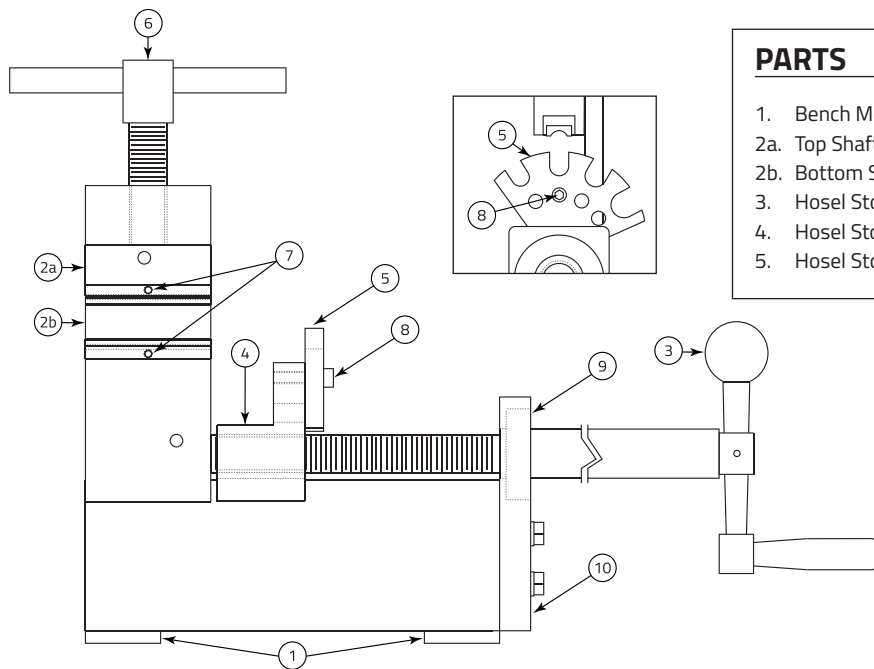

PARTS

- | | |
|----------------------------|-------------------------|
| 1. Bench Mount | 6. Shaft Clamp T-Handle |
| 2a. Top Shaft Clamp | 7. Shaft Clamp Screws |
| 2b. Bottom Shaft Clamp | 8. Hosel Stop Screw |
| 3. Hosel Stop Speed-Handle | 9. Speed-Handle Bearing |
| 4. Hosel Stop Guide | 10. Bearing Plate |
| 5. Hosel Stop (Selectable) | |

MAINTENANCE

Your Commercial Model Graphite Shaft Puller has been shipped to you with a thin coating of axle grease on the threaded rods. It is recommended that these areas be lubricated periodically to prevent wear. Occasionally clean rest of puller with WD40.

All bearings come pre-lubricated and do not require maintenance.

- 1** To install your Commercial EZ Model Graphite Shaft Puller on work bench, mark placement of holes for 5/16" bolts. (Not supplied) Use a 11/32" drill bit to drill 4 holes. Position the puller and bolt in place.
- 2** Turn the Top T-Handle (#6) counter clockwise to raise the Top Shaft Clamp (#2a). NOTE: Rubber used in the clamp protects and grips shaft for removal. No other protection is required.
- 3** Turn Hosel Stop Speed-Handle (#3) counter clockwise until the Hosel Stop Guide (#4) touches the Bottom Shaft Clamp (#2b). **NOTE:** Do not over tighten.
- 4** Selecting hosel stop: Remove Hosel Stop Screw (#8) and rotate hosel stop so that the correct diameter is in line with shaft clamps. Re-install hosel stop screw.
- 5** CUT OFF FERRULE before placing the golf club in your Commercial EZ Model Graphite Shaft Puller.
- 6** Place shaft into the Bottom Shaft Clamp (#2b) with club head hosel against Hosel Stop (#5). Turn the Shaft Clamp T-Handle (#6) clockwise to tighten the Top Shaft Clamp (#2a) down on the golf club shaft. **NOTE:** Do not over tighten. Shafts can be crushed.
- 7** Turn Hosel Stop Speed-Handle (#3) slightly until Hosel Stop (#5) is tight against club head hosel. Apply heat evenly around hosel until epoxy bond is broken. NOTE: On bore thru metal woods, it may be necessary to heat hosel for a few seconds, let heat conduct for a few minutes, then reheat. You may have to repeat this process a few times in order to prevent burning the finish on the club head. **IMPORTANT:** You must apply enough heat to break the epoxy bond or the club head will not pull off.
- 8** Turn the Hosel Stop Speed-Handle (#3) clockwise to pull club head from shaft. Hold the club head with your free hand so that it does not fall off the shaft. **NOTE:** Do not touch the hosel. Use glove to protect hand.

ATTENTION: Do not use puller to remove steel shafts. Heat will conduct up the steel shaft and damage the rubber clamps.