

**STEELCLUB® Graphite Shaft Puller**  
*Pro Plus Model*



**Maintenance**

Your Pro Plus Model Graphite Shaft Puller has been shipped to you with a thin coating of axle grease on the threaded rods. It is recommended that the threads be lubricated periodically to prevent wear. Occasionally clean rest of fixture with WD-40.

**Package Contents**

This package includes the following items:

1. Bench Mount
- 2a. Top Shaft Clamp
- 2b. Bottom Shaft Clamp
3. Hosel Stop Handle
4. Hosel Stop Guide
5. Hosel Stop (Selectable)
6. Shaft Clamp T-Handle
7. Roll Pins
8. Shaft Clamp Screws
9. Hosel Stop Screws

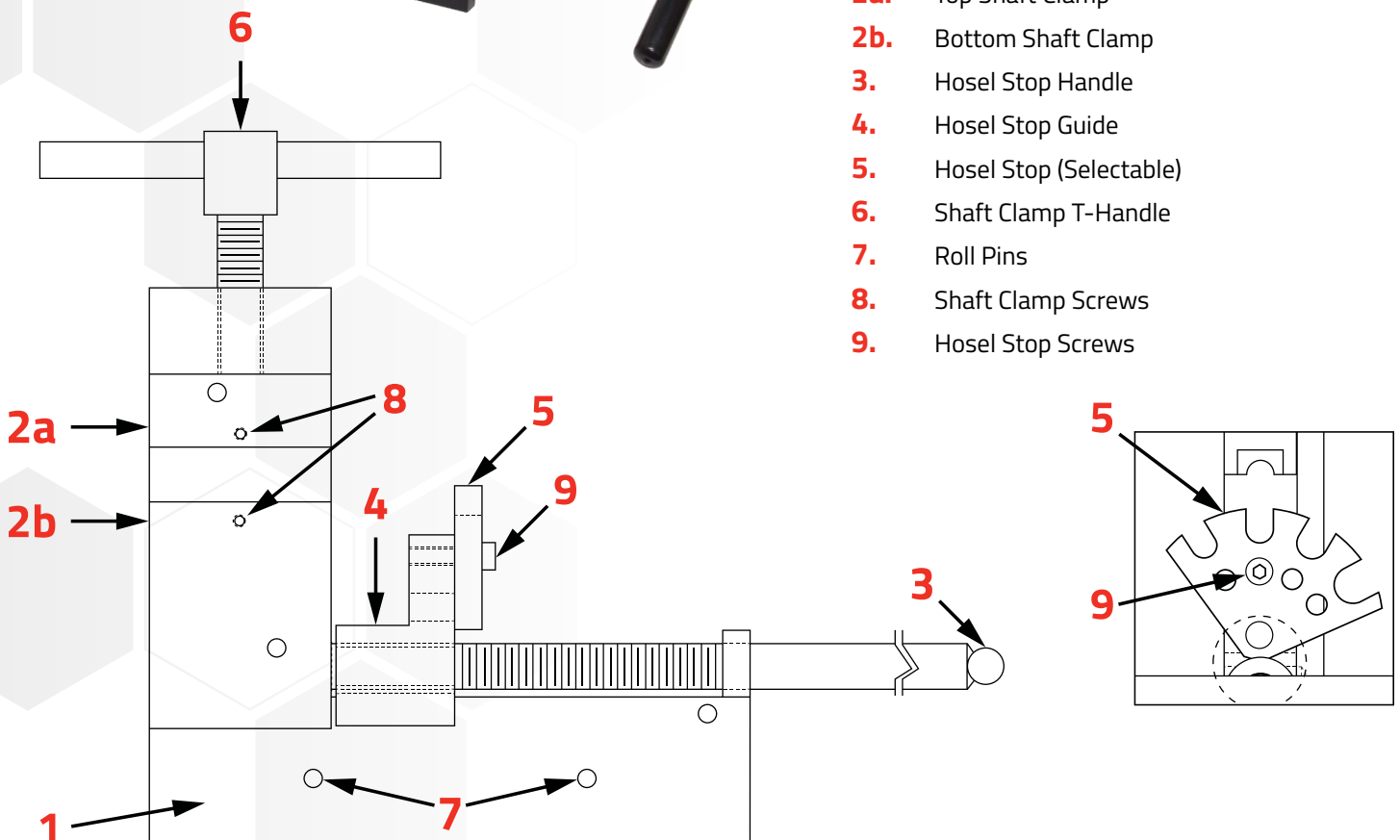

## Getting Started: Operating Instructions

### STEP 1

Secure your Pro Plus Model Graphite Shaft Puller in a vise. Set the **Roll Pins(7)** of **Vise Plate(1)** on top of vise jaws.

### STEP 2

Turn the **Top T-Handle(6)** counter clockwise to raise the **Top Shaft Clamp(2a)**.

**NOTE:** Rubber used in the clamp protects and grips shaft for removal. No other protection is required.

### STEP 3

Turn **Hosel Stop T-Handle(3)** counter clockwise until the **Hosel Stop Guide(4)** touches the **Bottom Shaft Clamp(2b)**.

**NOTE:** Do not over tighten.

### STEP 4

Selecting hosel stop: Remove **Hosel Stop Screw(8)** and rotate hosel stop so that the correct diameter is in line with shaft clamps.

Re-install hosel stop screw.

### STEP 5

Cut off Ferrule before placing the golf club in your Pro Plus Model Graphite Shaft Puller

### STEP 6

Place Shaft into the **Bottom Shaft Clamp(2b)** with club head hosel against **Hosel Stop(5)**. Turn the **Shaft Clamp T-Handle(6)** clockwise to tighten the **Top Shaft Clamp(2a)** down on the golf club shaft.

**NOTE:** Do not over tighten. Shafts can be crushed.

### STEP 7

Turn **Hosel Stop T-Handle(3)** slightly until **Hosel Stop(5)** is tight against club head hosel. Apply heat evenly around hosel until epoxy bond is broken. **NOTE:** On bore thru metal woods, it may be necessary to heat hosel for a few seconds, let heat conduct for a few minutes, then reheat. You may have to repeat this process a few times in order to prevent burning the finish off the club head.

**IMPORTANT:** You must apply enough heat to break the epoxy bond or the club head will not pull off.

### STEP 8

Turn the **Hosel Stop T-Handle(3)** clockwise to pull club head from shaft. Hold the club head with your free hand so that it does not fall off the shaft. **NOTE:** Do not touch the hosel. Use glove to protect hand.

**ATTENTION:** Do not use puller to remove steel shafts. Heat will conduct up the steel shaft and damage the rubber clamps.